



FIREPIT
OSLO



USER INSTRUCTIONS

Tools required (included)



IMPORTANT! – Carefully remove any packaging before use, but retain the safety instructions.
These instructions form part of the product.

Please take note of all of the safety warnings listed in these instructions.

Please read these instructions in their entirety and retain them for future reference.

These instructions should be stored with the product.

This product is for domestic use **ONLY** and should not be used commercially or for contract purposes.

Failure to adhere to these instructions could result in property damage, personal injury or death.

Parts list

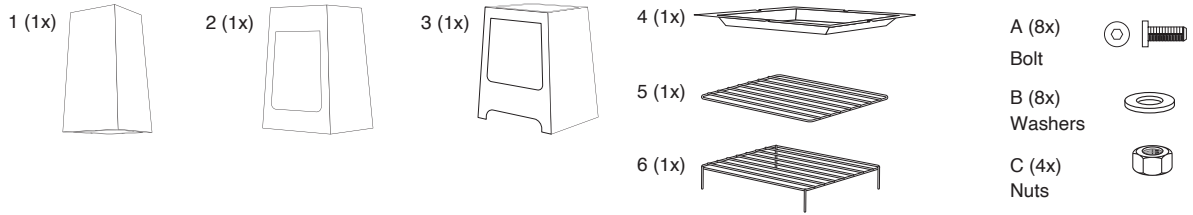

Prior to Assembly: Read the instructions carefully. Check all parts against the parts list. Carry out assembly on a soft surface to avoid scratching the paint. Please retain this information for future reference.

For ease of assembly only loosely tighten bolts and then tighten fully when assembly is complete.

WARNING! - DO NOT over tighten bolts; only tighten with moderate pressure to avoid damaging the bolts or components of the Chimenea.

Assembly diagram

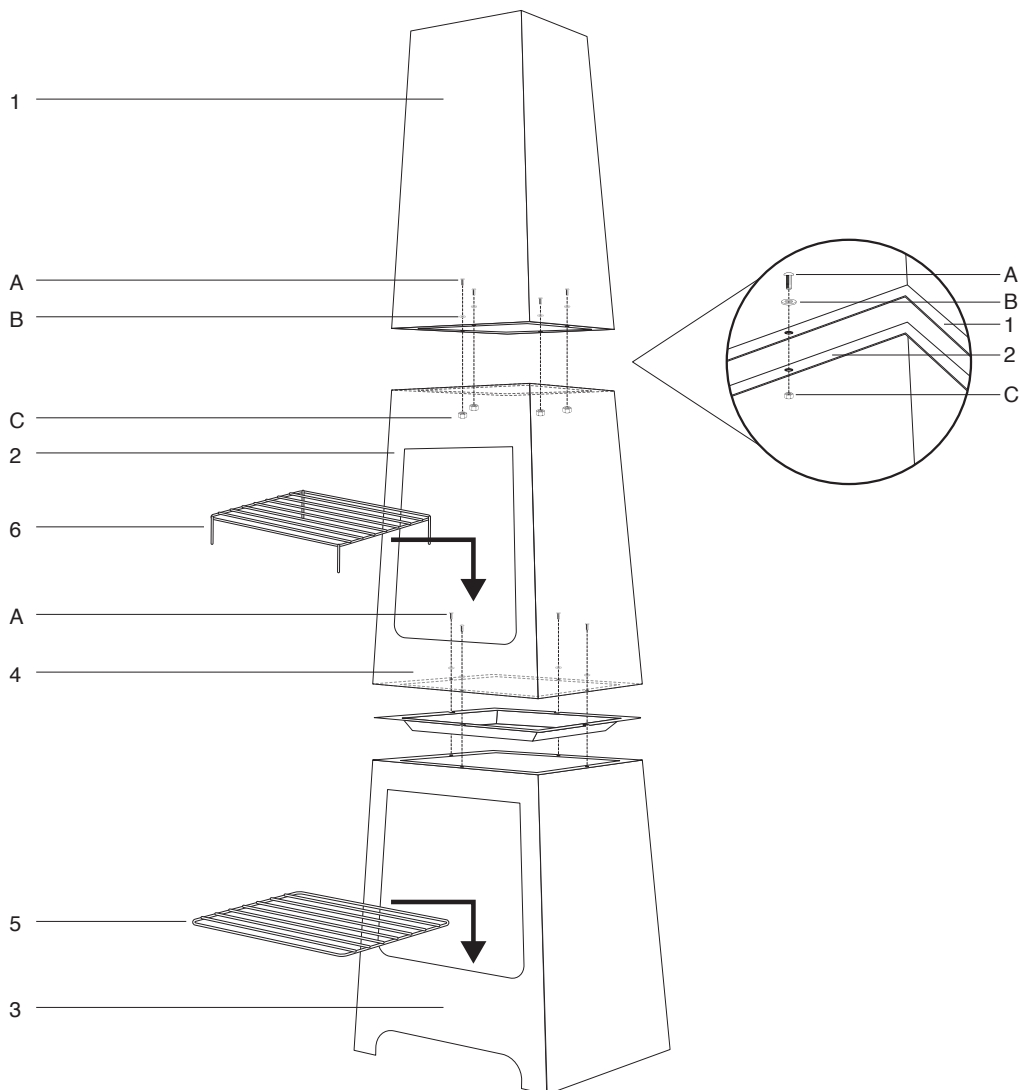

Assembly Instructions

IMPORTANT! - Remove any packaging before use, but retain the safety instructions and store them with this product.

ASSEMBLY

STEP 1 - Place the bottom section (3) on a flat surface and place the fuel tray (4) on top.

STEP 2 - Add middle section (2) on top of the fuel tray (4) and secure using 4x bolts and washers (A,B).

STEP 3 - Attach the flue section (1) to the body section (2) using 4x bolts, washers and nuts (A,B & C).

STEP 4 - Place the log grate (6) into the body section (2) of the Chimenea and place the log store grate (5) into base of Chimenea (3).

The Chimenea is now ready to use but please ensure you have read these instructions thoroughly prior to use.

WARNING!

LOG COMPARTMENT

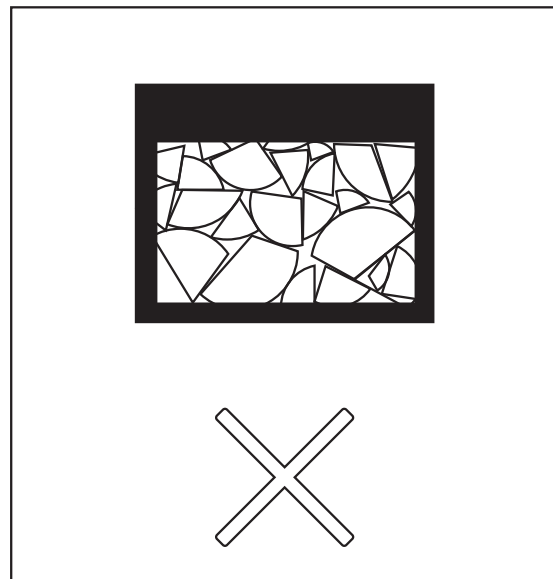
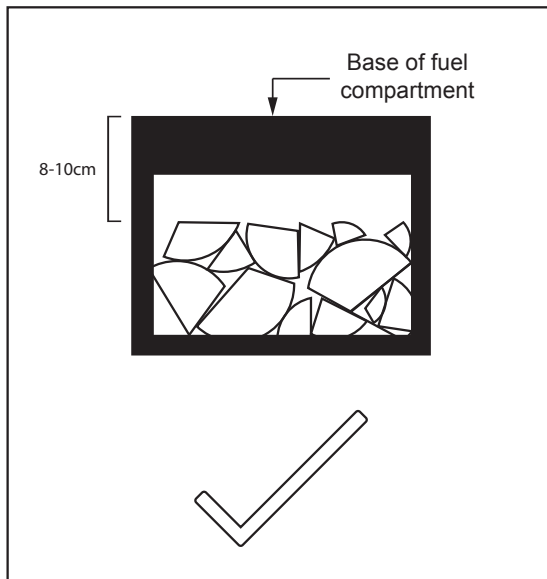

Only untreated logs should be stacked under the unit. These should be stacked no closer than 8-10cm from the base of the fuel compartment and should be loosely loaded to allow air flow. DO NOT place any other type of fuel under the firepit and DO NOT stack untreated logs tightly together or higher than advised, as this may damage the unit. DO NOT light a fire in the log store at the bottom of the chimenea.

Care and safe use guidelines

WARNINGS - CAUTION!

- **DO NOT USE INDOORS.**
- **WARNING!** - Keep children and pets away.
- **NEVER** leave a burning fire unattended.
- **DANGER** of carbon monoxide poisoning - **NEVER** light this product or let it smoulder or cool down in confined spaces.
- **DO NOT** use this product in a tent, caravan, car, cellar, loft or on a boat.
- **DO NOT** use under any awnings, parasols or gazebos.
- **FIRE HAZARD** - Hot embers may emit while in use.
- **WARNING!** - **DO NOT** use petrol, white spirit, lighter fluid, alcohol or other similar chemicals for lighting or relighting. **ONLY** use firelighters that comply to EN:1860-3.
- This product is **ONLY** suitable for use with untreated wood.
- **DO NOT** use this product on decking or any other flammable surfaces such as dry grass, wood chips, leaves or decorative bark.
- Ensure that the product is positioned at least 2m away from flammable items. Also ensure that there is a minimum overhead clearance of 2m from the top of the unit.
- **DO NOT** use this product as a furnace - **ONLY** use as a patio heater.
- **WARNING!** - This product will become very hot. **DO NOT** move it during operation.
- This product is **NOT** intended for cooking or heating food.
- Ensure there is a minimum gap of 6cm between the base of the firebowl (3) and fuel stored in the log store below, to allow air flow.

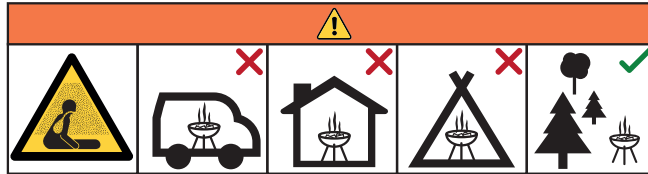

CARE & USE

- Ensure that the product is positioned on a permanent flat, stable, heat resistant, non-flammable surface away from flammable items.
- Ensure that the product has a minimum of 2m overhead clearance and has a minimum of 2m clearance from other surrounding items.
- Decide on the location as above. The assembled product is heavy and it is therefore recommended that the unit is not moved once positioned and must **NOT** be moved whilst in use. If it is necessary to move it once it has cooled, please use 2 persons to lift (do not drag) the product across the floor.
- The unit may be left outside for extended periods of time if a weatherproof cover is used to help protect it from bad weather.
- As this model is made from steel, the surface will age and develop surface rust as soon as it is placed outside and from first use. This is to be expected, does not affect use and is not a product fault. Please see below instructions on how to refresh the paint finish if desired.
- To help reduce surface rust, rub the product with an oily rag after each use.
- For safety reasons, always inspect your product prior to use for signs of fatigue and damage and replace your model as and when necessary. Continuing to use a damaged unit could cause personal injury or damage to property.
- **ALWAYS** use heat resistant gloves during use and when adding fuel.
- Please note that some fuels burn hotter than others and fires may cause the black powder coat finish to turn a lighter shade of grey around the area of the fire. This is normal and is not a product fault. The product may be repainted if desired using high temperature resistant paint to renew the finish.

LIGHTING & REFUELLING

- This product is **ONLY** suitable for use with untreated wood.
- Prepare a stack of loosely crumpled newspaper and place on top of the firebowl.
- Pile finely split dry firewood or kindling on top of the paper.
- To light the newspaper, use long safety matches or a long nose lighter.
- Once sufficiently alight, add logs or larger pieces of untreated wood to the unit to increase the heat slowly.
- **DO NOT** overload with fuel, only one or two logs is sufficient.
- **ALWAYS** use heat resistant gloves when adding fuel as the unit will become very hot.
- **ALWAYS** ensure that fuel does not protrude from the front or rear opening of the product.

EXTINGUISHING

- To extinguish unit – stop adding fuel and allow fire to die or douse with sand. **DO NOT** use water as this may damage the product.

STORAGE

- When not in use, and if stored outside, cover the product once it has cooled completely with a weatherproof cover.
- Remove loose paint and rust with a wire brush when needed and re-paint the product using High Temperature Paint.